

"DIN 94"

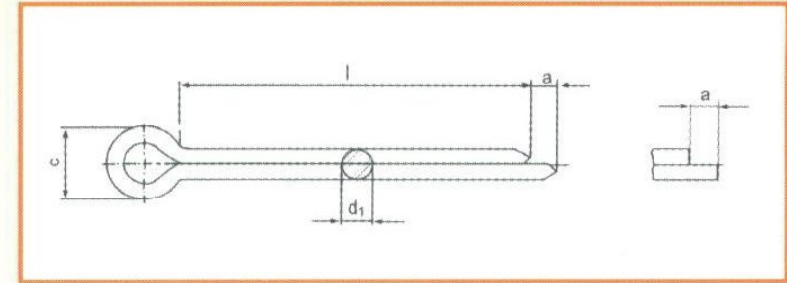

SPLIT PINS GUPİLYA SPLINTE



Technical informations. / Teknik bilgiler.

Thread size / Anma çapı		0.6	0.8	1	1.2	1.6	2	2.5	3.2	4	5	6.3	8	10	13	16	20
d_1	max.	0.5	0.7	0.9	1.0	1.4	1.8	2.3	2.9	3.7	4.6	5.9	7.5	9.5	12.4	15.4	19.3
	min.	0.4	0.6	0.8	0.9	1.3	1.7	2.1	2.7	3.5	4.4	5.7	7.3	9.3	12.1	15.1	19.0
a	max	1.6	1.6	1.6	2.5	2.5	2.5	2.5	3.2	4.0	4.0	4.0	4.0	6.3	6.3	6.3	6.3
	min.	0.8	0.8	0.8	1.25	1.3	1.3	1.3	1.6	2.0	2.0	2.0	2.0	3.2	3.2	3.2	3.2
c	min.	0.9	1.2	1.6	1.7	2.4	3.2	4.0	5.1	6.5	8.0	10.3	13.1	16.6	21.7	27.0	33.8

Values are given in millimeters. / Değerler milimetre olarak verilmiştir.

Thread size / Anma çapı		0.6	0.8	1	1.2	1.6	2	2.5	3.2	4	5	6.3	8	10	13	16	20
<i>Length / Boy (1)</i>		<i>Mass for 1.000 units in kg. / 1.000 Tanesinin ağırlığı.</i>															
14	+/- 0.90			0.07		0.16	0.31	0.57									
20	+/- 1.00					0.22	0.40	0.75	1.09	2.16	3.49						
25	+/- 1.00					0.27	0.47	0.90	1.31	2.52	4.00						
32	+/- 1.25					0.34	0.56	1.10	1.64	3.07	5.00	8.90					
40	+/- 1.25						0.66	1.34	2.00	3.71	6.00	10.6	17.2				
45	+/- 1.25							1.49	2.17	4.11	6.61	11.7	18.9				
50	+/- 1.25							1.64	2.43	4.51	7.24	12.8	20.6				
56	+/- 1.50								2.70	5.00	8.00	14.0	22.6	38.0	69.5		
63	+/- 1.50								3.02	5.55	8.67	15.6	25.0	41.8	76.0		
71	+/- 1.50								3.38	6.20	9.86	17.3	27.7	46.2	83.4		
80	+/- 1.50								3.78	6.91	11.0	19.2	30.7	51.2	91.8		
90	+/- 1.75									7.71	12.2	21.3	34.1	56.7	101		
100	+/- 1.75									8.51	13.5	23.5	37.5	62.2	111	171	